

# EZ SPRAY



## OPERATION MANUAL

Rx Only

Thank you for purchasing EZ SPRAY. This product enables an easy, effective system for lubricating various handpieces. Please read this operation manual carefully and thoroughly before operating product . Keep this operation manual on hand for future reference.

### Precautions for handling and operation

- Read these safety cautions thoroughly before use and operate the product properly.
- These indicators are to allow you to use the product safely, prevent danger and harm to you and others. These are classified by degree of danger, damage, and seriousness. All indicators concern safety, be sure to follow them.

Class	Degree of risk
 <b>DANGER</b>	Hazard that could result in personal death or serious injury if the safety instructions are not correctly followed.
 <b>WARNING</b>	Hazard that could result in serious injury or damage to the device if the safety instructions are not correctly followed.
 <b>CAUTION</b>	Hazard that could result in light or moderate injury or damage to the device if the safety instructions are not correctly followed.
<b>NOTICE</b>	General product specification information highlighted to avoid product malfunction and performance reduction.

### **DANGER**

- Do not direct EZ SPRAY towards fire during use.
- Do not use the product around heaters or stoves. Keep it away from fire.
- Do not use large amounts of the product in a place where fire is used.
- Do not use or leave the product where the temperature can go up to 40°C or more. Avoid direct sunlight.
- Do not put the product into fire.
- Do not attempt to disassemble the product or tamper with the mechanism.

### **WARNING**

- If you notice any problems this manual does not cover, such as a fluid or gas leak, stop using the product and contact your dealer.
- Do not spray the product at people.
- Do not mount this product to any spray can except PANA SPRAY Plus. Using other spray cans may cause fluid or gas leaks.
- Do not subject the product to strong impact, especially by dropping it on a hard surface. Set PANA SPRAY Plus on a flat and stable surface.
- Turn the ON/OFF valve off when you mount the product to PANA SPRAY Plus, or when you are not using it.

### **CAUTION**

Do not remove the product from PANA SPRAY Plus before emptying the spray can completely.

# 1. Names of parts



	Names of products	Qty
①	EZ SPRAY GRIP (comes as a set with ③)	1
②	ON/OFF Valve	1
③	Coil Tube (comes as a set with ①)	1
④	Grip Holder	1
⑤	Spray Holder	1
⑥	O-Rings	2
⑦	Spray Mist Absorber	1
⑧	PA Nozzle	1
⑨	PANA SPRAY Plus (NOT included in the package)	-

# 2. Assembly

## ⚠ CAUTION

- Turn the ON/OFF Valve lever to the OFF position before assembly.
- If the ON/OFF Valve is not inserted straight, a gap between PANA SPRAY Plus and the nozzle will occur, a fluid leak.

## 1. Mounting the ON/OFF Valve

### ⚠ CAUTION

When you mount the ON/OFF Valve to PANA SPRAY Plus, make sure it is inserted straight. If O-ring comes off, gets twisted, or becomes damaged, it may cause a fluid leak.

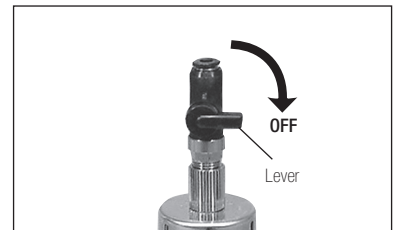

Fig. 1

(1) Turn the ON/OFF Valve lever to the OFF position. (Fig. 1)

(2) Remove the Spout Cap from PANA SPRAY Plus. (Fig. 2)

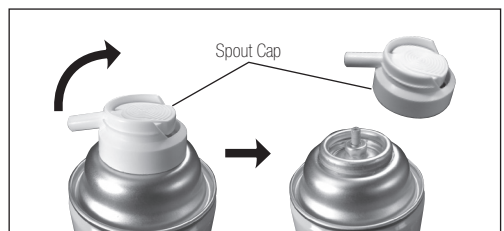

Fig. 2

(3) Hold PANA SPRAY Plus firmly in your hands, and insert the ON/OFF Valve straight into it. (Fig. 3)

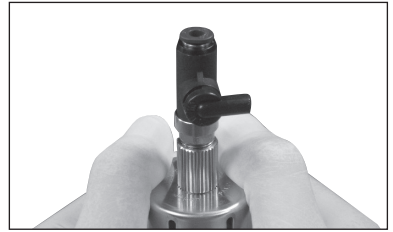

Fig. 3

## 2. Mounting the Grip Holder

### ⚠ CAUTION

Make sure to mount the Grip Holder in the way shown in Fig. 4. If mounted upside down, it will not hold the ON/OFF Valve tightly and will easily dislodge.

While holding PANA SPRAY Plus firmly, put the Grip Holder on to the ON/OFF Valve and push it down until it is even with the upper surface of the ON/OFF Valve. (Fig. 4)

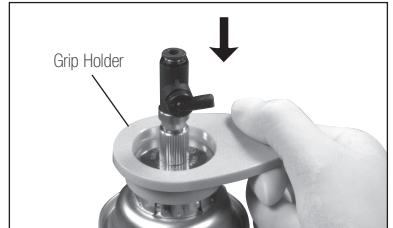

Fig. 4

## 3. Mounting the Coil Tube

### ⚠ CAUTION

After mounting the Coil Tube, pull it lightly to make sure it is fitted securely. If the Coil Tube is not inserted deep enough, the gas pressure will cause it to dislodge.

- (1) Turn the ON/OFF Valve lever to the OFF position. (Fig. 5)
- (2) Hold the upper part of the PANA SPRAY Plus firmly.
- (3) Insert the Coil Tube into the Connection Hole of the ON/OFF Valve until you can feel it stop. (Fig. 6)
- (4) With more force, push the Coil Tube in until it is completely inserted.

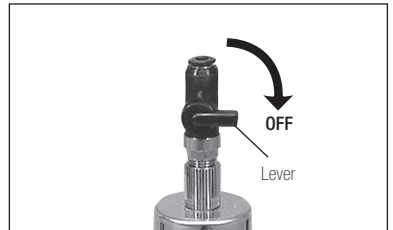

Fig. 5

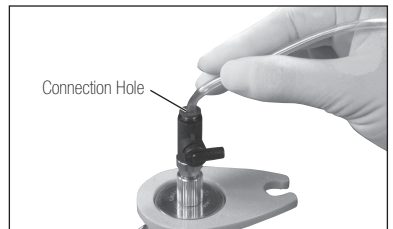

Fig. 6

### 3. Lubrication

#### 1. Names and functions of EZ SPRAY GRIP parts

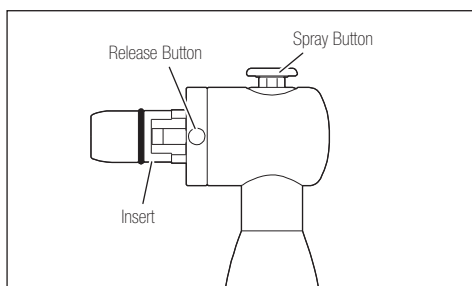

Fig. 7

- Spray Button: By pressing this button, PANA SPRAY Plus is dispensed.
- Insert: EZ SPRAY GRIP can be directly connected to a handpiece by this part.
- Release Button: By pressing this button, the handpiece dislodges.

#### 2. Lubricating a handpiece

##### NOTICE

Lubricate handpieces according to the operation manual.

##### ⚠ CAUTION

- Shake the spray can well before use.
- Before spraying, make sure the handpiece is inserted properly and is secure. If the connection is loose, the handpiece will dislodge due to the gas pressure.
- Do not press the Release Button of EZ SPRAY GRIP while spraying. The gas pressure will cause the handpiece to dislodge.

- (1) Shake PANA SPRAY Plus well.
- (2) Turn the ON/OFF Valve lever to the ON position. (Fig. 8)
- (3) Put the end of the handpiece all the way into the Insert of EZ SPRAY GRIP. (Fig. 9)
- (4) Insert the head of the handpiece into the Spray Mist Absorber. (Fig. 10)
- (5) Hold the handpiece and the Spray Mist Absorber firmly and press the Spray Button to spray until the solvent appears clear.
- (6) Turn the ON/OFF Valve lever to the OFF position once when the handpiece is lubricated.

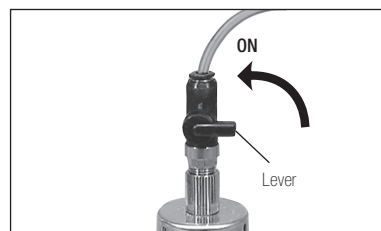

Fig. 8

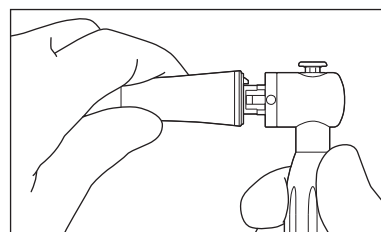

Fig. 9

To remove the handpiece, pull it off straight while pressing the Release Button.

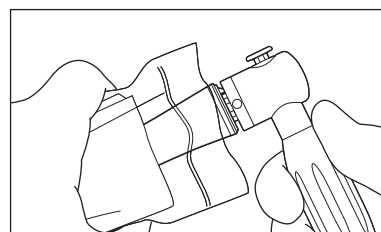

Fig. 10

##### NOTICE

Exchange Spray Mist Absorbers when oil spreads throughout a pack.

\*Refer to "6. Spare Parts and Option List"

## 4. Removing parts

### ⚠ CAUTION

Before removing any parts, make sure to empty PANA SPRAY Plus by pressing the EZ SPRAY GRIP Spray Button.

### 1. Removing the Coil Tube

- (1) Turn the ON/OFF Valve lever to the OFF position. (Fig. 11)
- (2) Insert the EZ SPRAY GRIP's insert into the Spray Mist Absorber, and press the Spray Button to discharge any residual oil remaining in the Coil Tube.
- (3) Hold the upper part of PANA SPRAY Plus and pull off the Coil Tube while pushing down on the Connection Hole as hard as possible. (Fig. 12)

### ⚠ CAUTION

Do not pull off the Coil Tube using force. It could damage the Coil Tube and hastens deterioration.

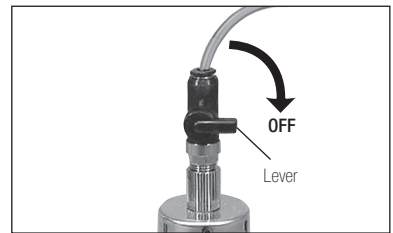

Fig. 11



Fig. 12

### 2. Removing the ON/OFF Valve

- (1) Turn the ON/OFF Valve lever to the OFF position. (Fig. 13)
- (2) Insert the tip of a screwdriver (approx. 4 mm in diameter) into the hole on the side of the ON/OFF Valve cap. (Fig. 14)
- (3) Hold PANA SPRAY Plus firmly and turn the screwdriver in the direction of the arrow to remove the ON/OFF Valve. (Fig. 15)

### ⚠ CAUTION

Make sure to hold each part firmly, otherwise the contents of PANA SPRAY Plus may spray when the ON/OFF Valve comes off.

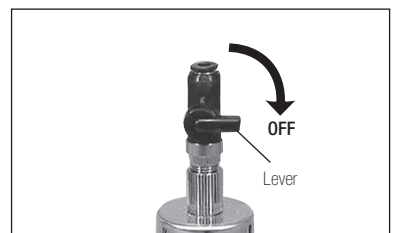

Fig. 13

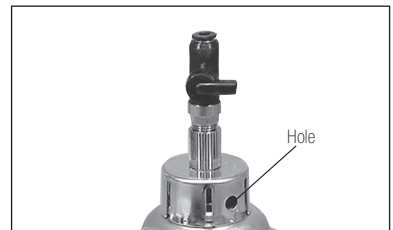

Fig. 14



Fig. 15

## 5. Changing O-rings

Change the O-ring(s) when there is a fluid leak.

### 1. ON/OFF Valve

- (1) Remove two defective O-rings with tweezers or a similar instrument from inside the ON/OFF Valve's Connection Part.
- (2) Set two new O-rings (included in the package) in the O-ring Groove (hatched area in Fig. 16) with tweezers or a similar instrument.

\*Refer to "6. Spare Parts and Option List"

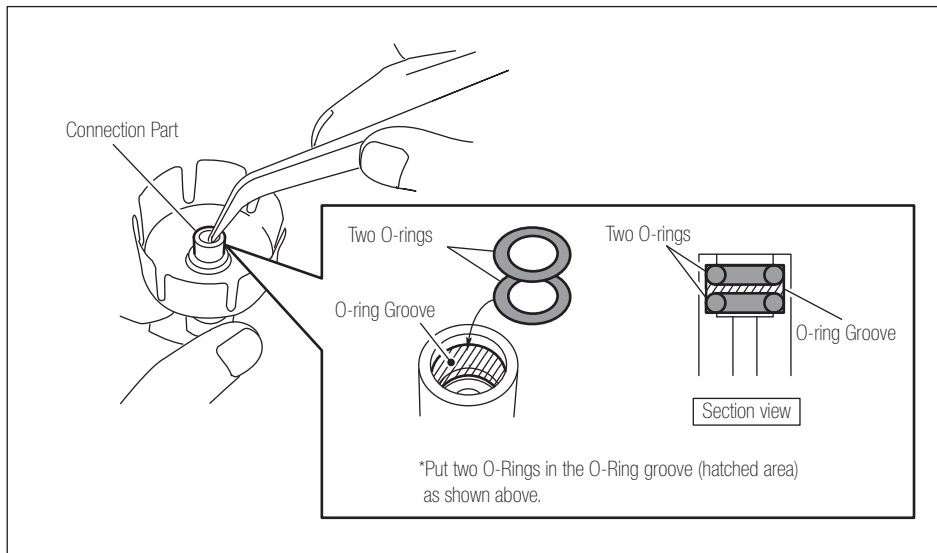

Fig. 16

### ⚠ CAUTION

When you mount the ON/OFF Valve to PANA SPRAY Plus, make sure it is fixed on straight. Otherwise, O-rings may dislodge, get twisted, or become damaged, which can cause fluid leaks.

### 2. EZ SPRAY GRIP

- (1) Remove the O-ring to be replaced by adding slack with your fingertips.
- (2) Set the new O-ring in the groove where the removed O-ring was seated.

\*Refer to "6. Spare Parts and Option List"

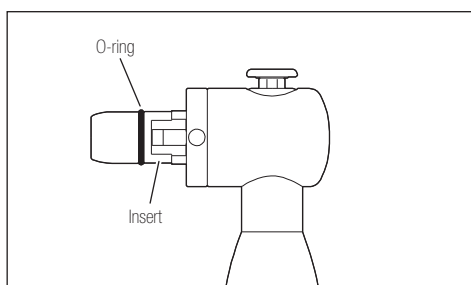

Fig. 17

## 6. Spare Parts and Option List

Model	Order Code	Remarks
EZ SPRAY GRIP	Z229011	
Coil Tube	Z229135	
Grip Holder	Z229201	
Spray Holder	Z229020	
ON/OFF Valve	Z229017	
PA Nozzle	Z229030	For 2 Hole / 3 Hole / 4 Hole
KV-Adaptor	Z257020	For KaVo handpieces
WH-Adaptor	Z257021	For W&H handpieces
EZ-M4 Adaptor	Z229040	For KV-Adaptor / WH-Adaptor
PTL Nozzle	Z229035	For NSK Phatelus / Mach handpieces
Spray Mist Absorbers	Y900084	Pack of 10
O-ring	D0312032120	For ON/OFF Valve
O-ring	D0312060100	For EZ SPRAY GRIP

